

How to use your glucometer (G-427B)?

Wash your hands with a fragrance-free soap

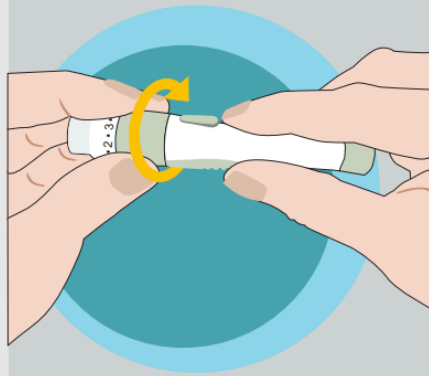

1



Screw the lancing device cap off

2

Firmly insert the lancet into the bottom half of the lancing device until you hear a click

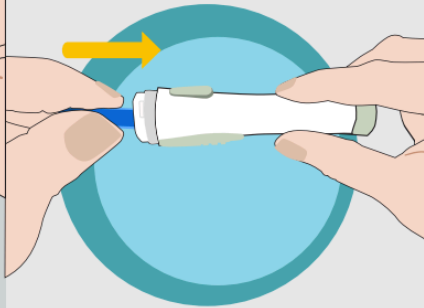

The bottom grey portion of the pen must be pulled to lock the lancet in place.

3

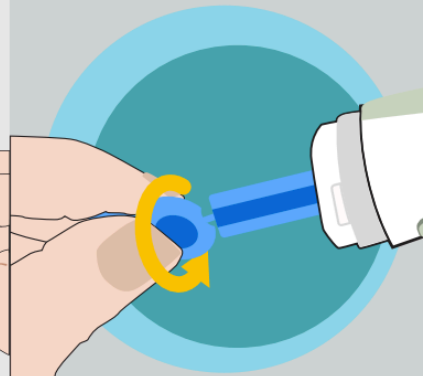

Twist the circular tab and pull gently to remove it

4

Place the cover back and adjust the proper level (usually level 3)

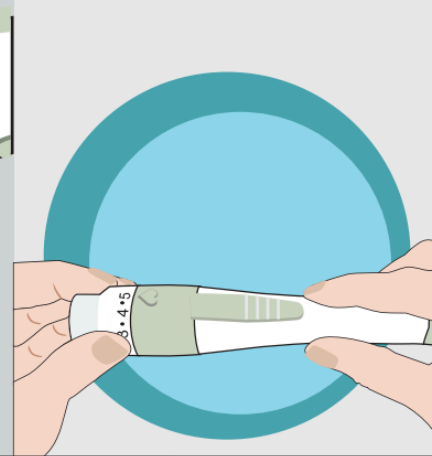

5

Make sure your device is not plugged in and insert a test strip, blue side facing up into your device



6

Squeeze finger until a slight change in color

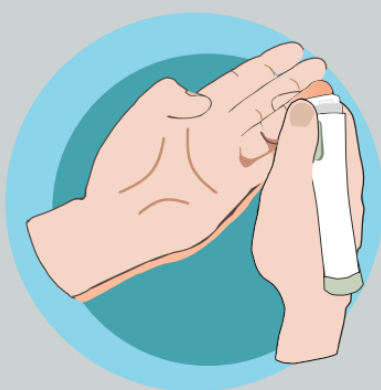

Then prick your fingertip by pressing the button under the heart symbol

7

Place the tip of the strip near the drop of blood. Until the blood enters the strip



8

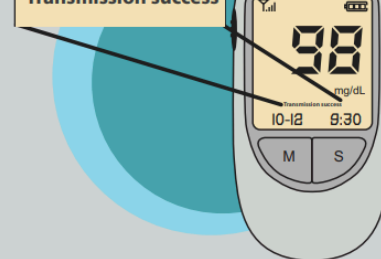

Countdown will be going and the left bottom corner will appear while flashing "In transit" Wait until your device displays "Transmission success" and it will shut off on its own

9

Eject the used test strip and push the ejection button to discard the used lancet in the old plastic carton

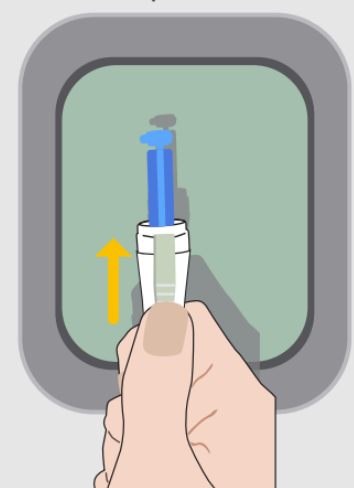

10